

Drawing: R:\TENANT COORDINATION\Rimrock Mall_Billings MT00 CAD DRAWINGS\01_RIM MALL\RIM_2019-11-01.dwg_Layout_Lease Plan 11x17_Oct 24, 2019, 11:03am



Mall Address:

RIMROCK MALL
300 S. 24th Street West
Billings, MT 59102-5650
Phone: (406) 656-3206
Fax: (406) 656-9174

Note:
This is a schematic plan only intended to show the general layout of the shopping center or part thereof. All the dimensions shown on this drawing should be field verified.

LEASE PLAN

LAST UPDATED: 11.01.19



STARWOOD RETAIL PARTNERS
1 E. Wacker Drive, Suite 3600
Chicago, IL 60601
Phone: (312) 242-3200

0 .5 1
SCALE: 1"=80'-0" @ 11x17



NORTH

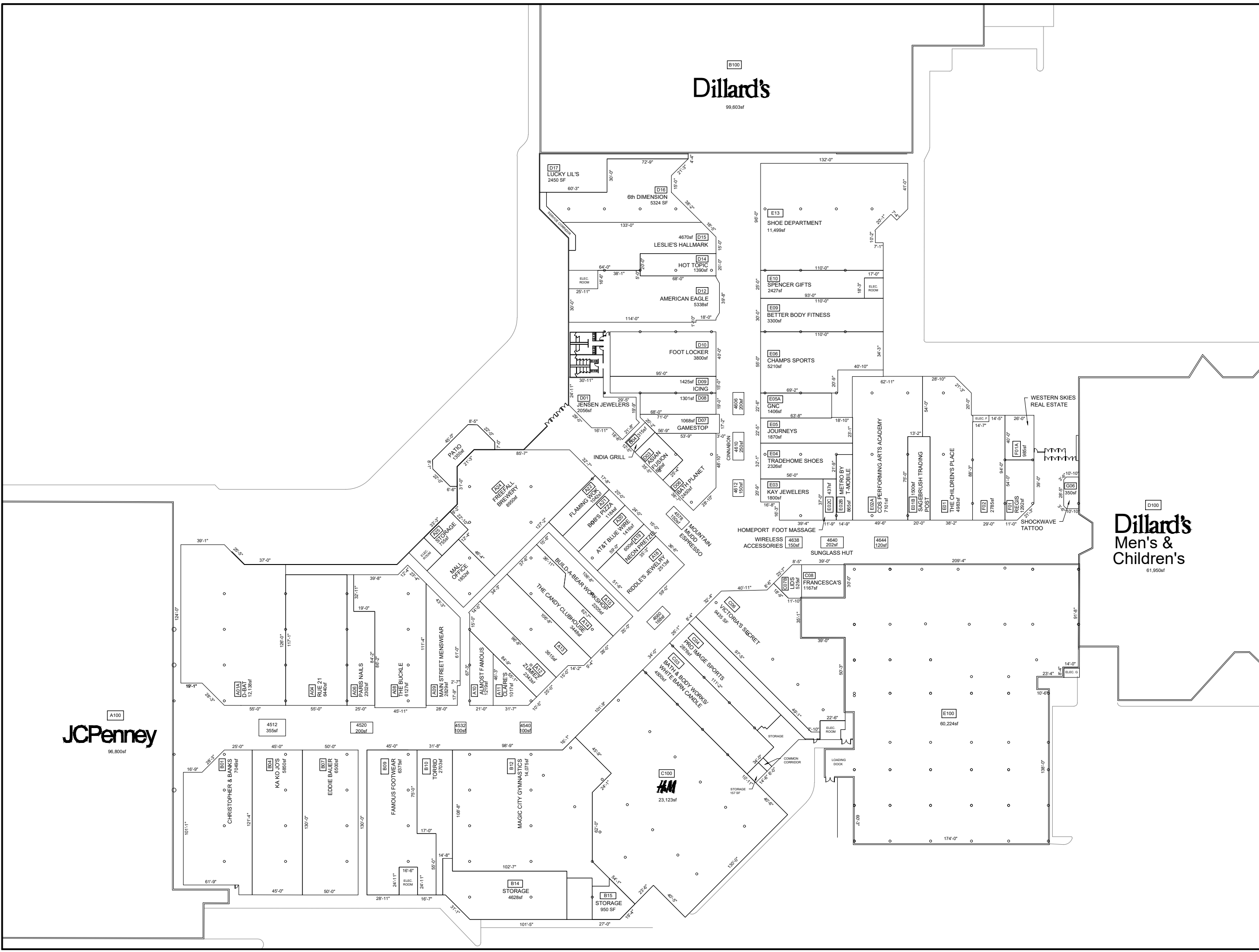

JCPenney
96,800sf

Dillard's
99,603sf

Dillard's
Men's &
Children's
61,950sf

H&M
23,123sf

